

Adapt to any
adventure and
any budget.



SOLIS

QUALITY INNOVATION SERVICE

WINNEBAGO



On the Cover: Bright White Full-Body Paint
Interior: 59P Nomad with Murphy+ Bed

Designed for Adventure

Experience the all-new Solis™ a camper van designed to take you and your family wherever the road leads you. With room for four and all the comforts and conveniences of home, the Solis is practical, versatile and affordable – all in one easy-driving package.

- **POP-UP TOP** Sleep closer to the stars with the easy-to-use molded fiberglass pop-top and FROLI® Sleep System built to comfortably sleep two.
- **PREMIUM INSULATION** Keep weather at bay and the sounds of the road out with ceiling-to-floor insulation, zipped air barrier window coverings, and interior coach waterlines.*
- **220-WATT FLEXIBLE SOLAR PANEL** Go off the grid and stay fueled. The one-panel system is fitted to the top of the pop-top roof for a sleek and unique look.
- **WATER, SIMPLIFIED** Features like dual exterior showers, cassette toilet, simplified water panel, easy-to-read freshwater tank sight glass with backlighting, and the Eco-Hot™ water system keep you on the go and stress-free.
- **FLEXIBLE SEATING OPTIONS** The dinette features automotive-grade seating with three-point belts for more secure travel. An optional sofa/bed (59P) provides comfortable seating for up to six as well as additional sleeping capacity.



The compact, functional galley includes an LP cooktop, countertop extension and compressor-driven refrigerator accessible from inside or outside the coach.

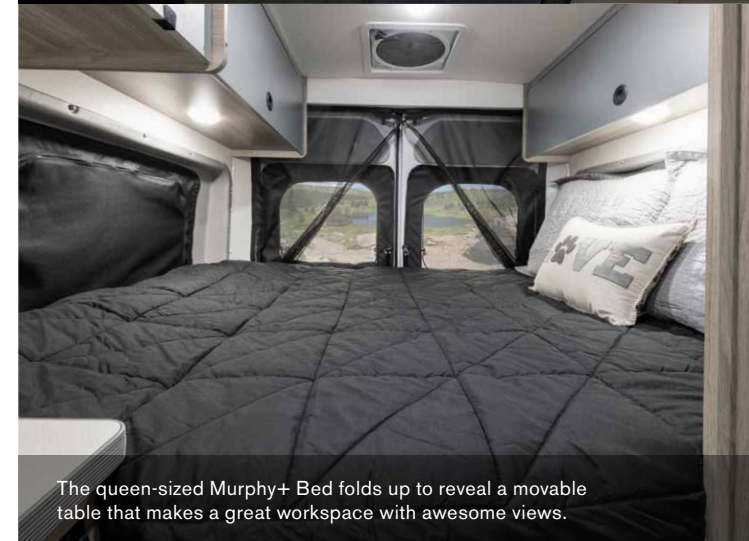

The queen-sized Murphy+ Bed folds up to reveal a movable table that makes a great workspace with awesome views.

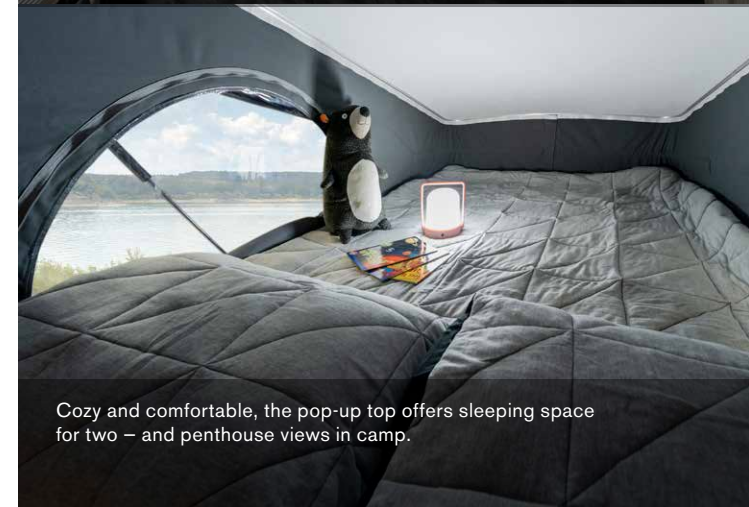

Cozy and comfortable, the pop-up top offers sleeping space for two – and penthouse views in camp.

WEIGHTS | MEASURES

	59P	59PX
Length	19'9"	21'
Exterior Height	8'11"	9'5"
Exterior Width	6'8"	6'8"
Interior Height	6'2"	6'2"
Interior Width	6'4"	6'4"
Freshwater Tank Capacity (gal.)	21	21
Water Heater Capacity (gal.)	2.6	2.6
Cassette Toilet Capacity (gal.)	5	5
Holding Tank Capacity - Gray (gal.)	20	20
LP Capacity (lbs.)	24.96	24.96
Fuel Capacity (gal.)	24	24
GCWR (lbs.)	11,500	11,500
GVWR (lbs.)	8,900	9,350
GAWR - Front (lbs.)	4,629	4,629
GAWR - Rear (lbs.)	5,291	5,291
Wheelbase	159"	159"*

* Extended wheelbase

HowToSolis.com

A Quick Start Guide At Your Fingertips

What do you need to know before you go?
And how does that cassette toilet work again?

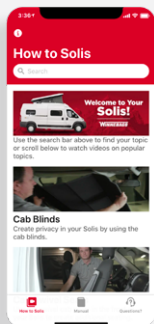

The answers to these and many more questions are literally at hand, thanks to HowToSolis.com, the app-based system of how-to videos that explains pretty much everything you need to know to get the most out of your Solis.

From adjusting seats and lowering (or raising) a bed, to operating major systems, plumbing and electrical basics, even winterization – it's all here. And it's all at your fingertips wherever your Solis takes you.



Scan the QR code with your smartphone camera, or type in the URL, to download the app and learn more about the Solis.

SOLIS // 59P NEW

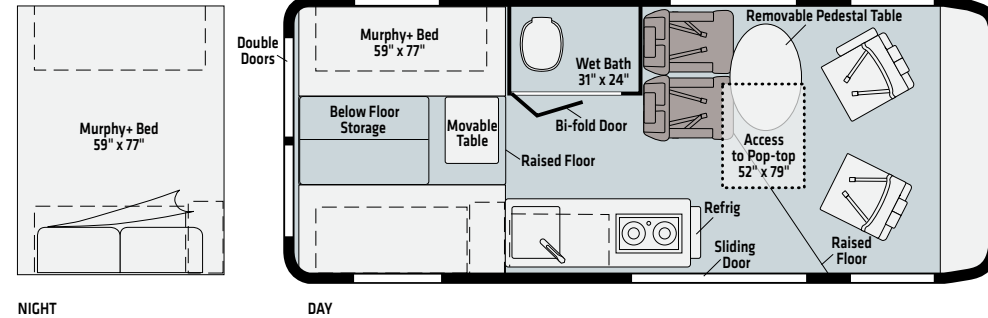

NIGHT

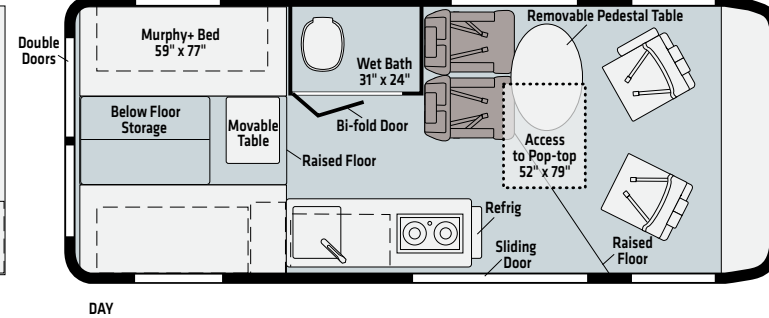

DAY

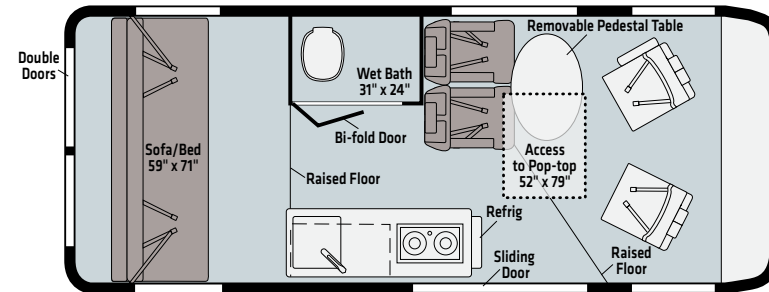

The movable table is not included with the Sofa/Bed option.

SOLIS // 59PX NEW

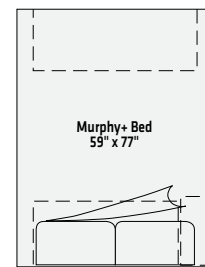

NIGHT

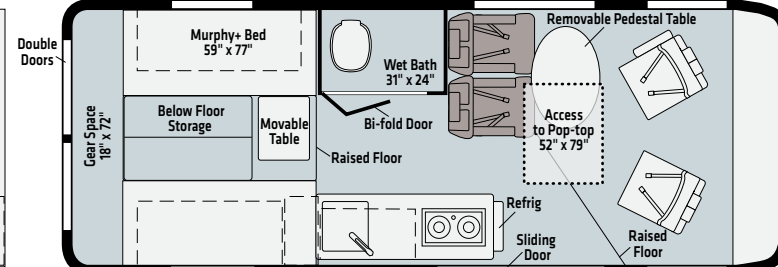

DAY



ECO-HOT™
WATER SYSTEM

REFRIGERATOR
COMPRESSOR
DRIVEN

Ultrafabrics
UF2 Premium
Leatherette

Vinyl

Dashed lines denote overhead storage areas. Floorplans and specifications are also available online at Winnebago.com

INTERIOR

NOMAD



Ultrafabrics UF2 Premium Leatherette



Wall Board



Bed Cover



Countertop



Vinyl Flooring



Wood - Weathered Teak

EXTERIOR

BRIGHT WHITE



DEEP CHERRY



i Visit [Winnebago.com](https://www.winnebago.com) for more info

+ Join a boundless community of adventurers in the Owners Section of [Winnebago.com](https://www.winnebago.com)

f Connect with other Solis owners on the **Winnebago Solis Owners and Wannabes** Facebook group.

©2020 Winnebago Printed in USA 08/20

Because features, specifications, equipment, and options may vary from those highlighted in this brochure, the buyer is responsible for confirming with the dealer the features, specifications, equipment, and options included on their specific vehicle. In addition, Winnebago's program of continuous product improvement may result in changes to vehicle specifications, equipment, model availability, and price without notice.

** Winnebago recommends following the winter use guidelines and winterization procedures outlined in your owner's manual whenever camping in freezing conditions.*

A HISTORY OF FIRSTS

- Innovative floorplans and SmartSpace™ design for spacious living & storage
- Equipped with Industry-leading technology
- Unmistakable interior and exterior style

RELY ON THE W

- Most advanced parts supply & service system in the industry
- Experienced Customer Care and Technical Support teams for personal assistance
- Unparalleled passenger safety

BUILT TO GO FURTHER

- Superior steel SuperStructure™ construction
- Thoughtfully designed service access
- Handcrafted furniture and parts with easy replacement

For more information visit
WINNEBAGO.COM

WINNEBAGO
BOUND BY THE W™